



## Music City Star East Corridor Commuter Rail Monthly Construction Update – January 2006

### Highlights / Accomplishments

- Grade Crossing signals in both phases and CTC signal installation continues.
- The landscaping and lighting were installed at both the Lebanon and Mt. Juliet Stations
- The platform was completed and utility work continued at the Hermitage Station
- Utility and platform work continued at the Donelson Station
- The timber building and train shed were erected and closed in at Riverfront Station
- Construction of the Lebanon Layover Facility commenced
- The remaining Phase II work was added into each of the contracts so that all the planned work remaining is now under contract

### Critical Issues

- Finalizing the integrated construction schedule now that all work is funded and obligated

### Construction Safety

- Roadway worker safety training continued to be given to the Contractor's Personnel
- Weekly Construction meetings were held with all the Contractors
- There were no lost time injuries on the site this month

### 90 Day Look Ahead

- Queen City will conclude all work currently under contract
- Stansell Electric will continue installing grade crossing signals on Phase II crossings and continue installation of train signals
- Mt. Juliet and Lebanon Station paving will commence
- Platform and utility work will continue at Donelson and Hermitage

## Construction Pictures



January 26, 2006 – Roofing Installation at Riverfront Station

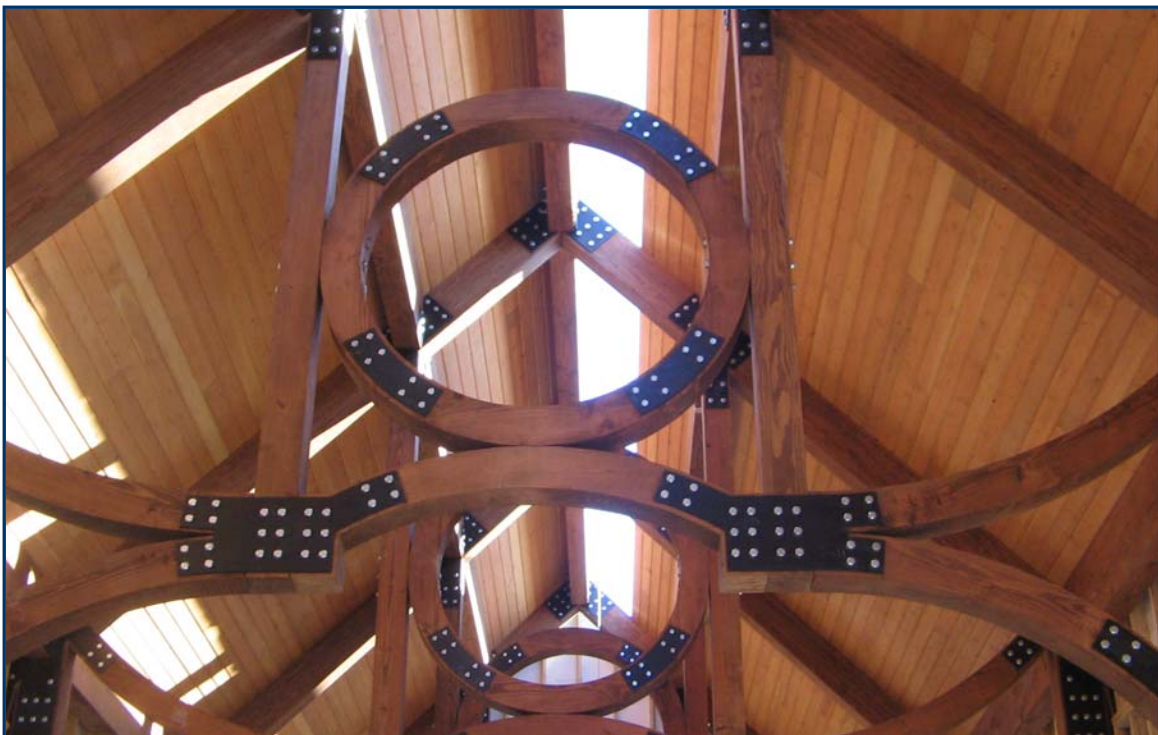

January 26, 2006 – View of Ceiling and Timber Framing from inside Riverfront Station



**January 31, 2006 – View of Grading and Light Foundations at Donelson**



**January 26, 2006 – Mt. Juliet Station with Landscaping and Lights**